

FOR LEASE

INDUSTRIAL OUTDOOR AND INDOOR STORAGE / TRUCK TERMINAL

3 Acre site with 32,000 sf building - Dock high and drive-in loading

Minutes from Downtown Atlanta and International Airport

281 Mt Zion Road SW, Atlanta, GA



Michael Habif
404.522.9358 ext. 2
Mhabif@habifproperties.com

HABIF
PROPERTIES





TABLE OF CONTENTS

3 PROPERTY SUMMARY

4 RETAIL CORRIDOR OVERVIEW

5 PHOTOS – Exterior

7 PHOTOS – Interior

8 FLOOR PLAN

PROPERTY SUMMARY

- **Property:** 3 acres
- **Outdoor Storage:** 98,000 sf paved and fenced surface lots with electric gate
- **Building:** 32,000 sf includes 10,000 sf warehouse with dock high loading, 1,230 sf air-conditioned office and multiple truck & auto service bays.
- **Loading Doors:**
 - 5 dock high loading doors with levelers
 - 5 oversized truck drive-in service bays
 - 6 drive-in 10' garage doors.
- **Ceiling Height:** 14' in warehouse; 21' in three truck service bays; 12' in other areas.
- **Zoning:** I-1 Light Industrial
- **Location:** One mile from Cleveland Ave interchange on I-75 with easy access to I-85, I-20 and I-285. Minutes from downtown Atlanta, Hartsfield Jackson International Airport and Atlanta's burgeoning Aerotropolis. Excellent visibility from I-75 with 175,00 plus vehicle count per day.
- **Additional Features:**
 - Paint booth
 - Opportunity Zone
 - Metropolitan Parkway Tax Allocation District



RETAIL CORRIDOR OVERVIEW



EXTERIOR PHOTOS - 281 Mt. Zion Rd.



HIGHWAY EXPOSURE - 281 Mt. Zion Rd

Seen by 175,000 Vehicles Per Day on I-75



INTERIOR PHOTOS - 281 Mt. Zion Rd.



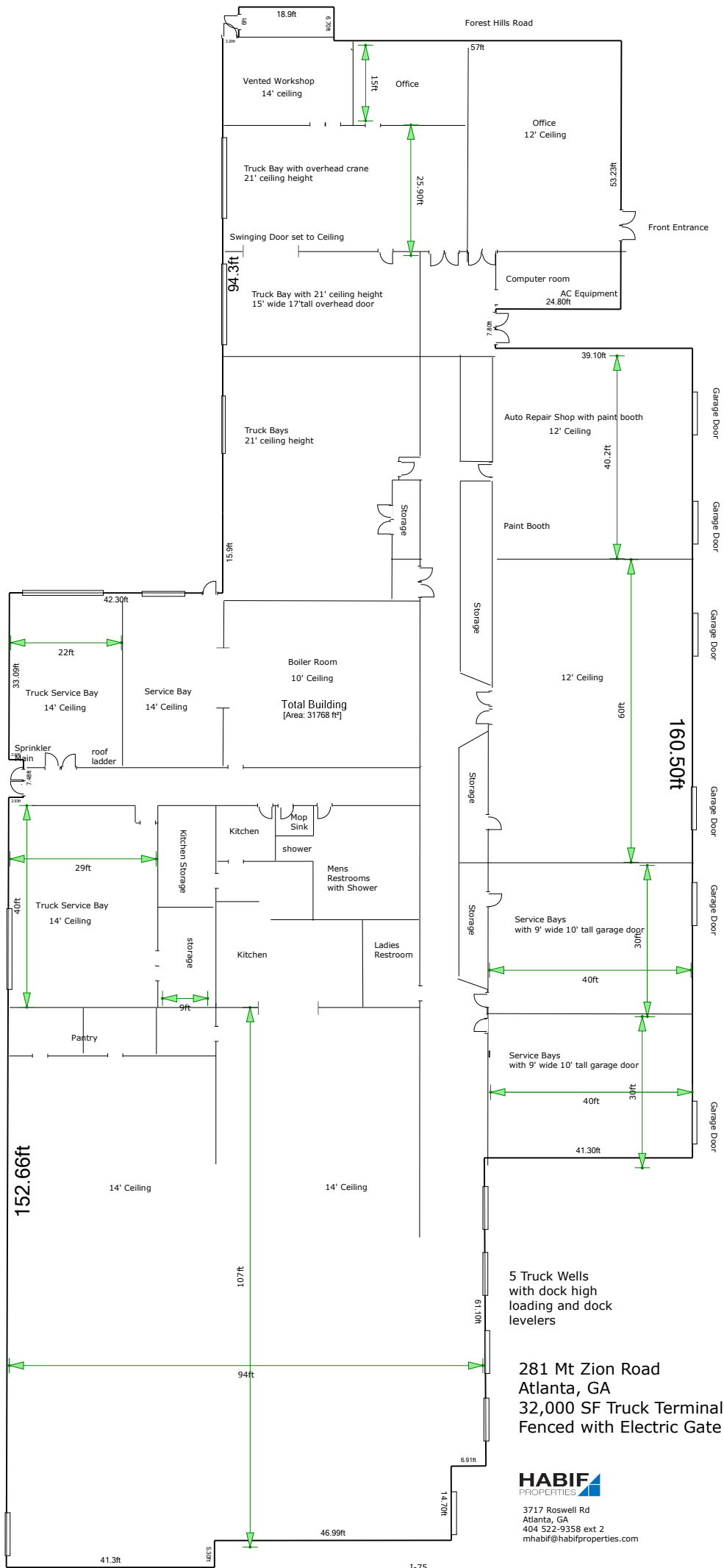

5 Truck Wells with dock high loading and dock levelers

281 Mt Zion Road
Atlanta, GA
32,000 SF Truck Terminal
Fenced with Electric Gate

HABIF
PROPERTIES

3717 Roswell Rd
Atlanta, GA
404 522-9358 ext 2
mhabif@habifproperties.com

